

Thimbles

solid type

- **Material** : malleable cast iron
- **Standard** : to B.S. 464 table 3 - 1958
- **Finish** : self colour or hot dipped galvanised
- **Note** : as standard the castings are supplied unmachined, for the B.S. 464 to apply thimbles require machining of both sides

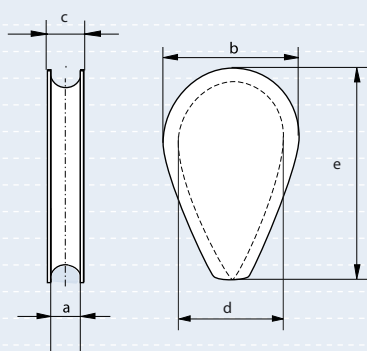
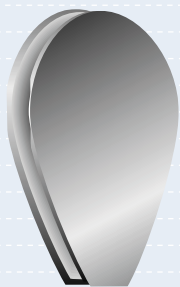

diameter rope	width overall	width outside *	width inside	length overall	maximum hole permitted **	weight each
a	b	c	d	e	**	kg
inch	inch	inch	inch	inch	inch	
5/16	1 3/8	7/16	1	1 7/8	1/2	0.09
3/8	1 3/4	9/16	1 1/4	2 1/4	5/8	0.17
7/16	2 1/16	11/16	1 1/2	2 3/4	3/4	0.30
1/2	2 3/8	13/16	1 3/4	3 1/4	7/8	0.42
5/8	2 3/4	7/8	2	3 3/4	1	0.54
3/4	3 3/8	1 1/8	2 1/2	4 5/8	1 1/4	1.19
7/8	3 3/4	1 1/4	2 3/4	5	1 3/8	1.72
15/16	4 1/8	1 5/16	3	5 1/2	1 1/2	2.13
1	4 1/2	1 7/16	3 1/4	6	1 5/8	2.57
1 1/8	4 7/8	1 9/16	3 1/2	6 1/2	1 3/4	3.06
1 1/4	5 1/2	1 3/4	4	7 1/2	2	4.52
1 3/8	6 1/8	2	4 1/2	8 1/4	2 1/4	6.51
1 1/2	6 3/4	2 1/4	5	9 1/4	2 1/2	9.20

* dimension shown as c - width outside is the finished size after machining both sides and not the size of the casting as offered as standard

** the maximum pin hole size permitted in the standard

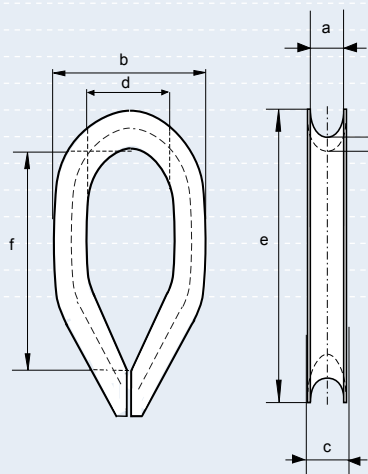
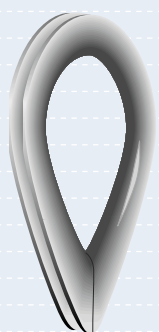

Reeving Thimbles

British standard

- **Material** : mild steel
- **Standard** : to B.S. 464 table 2 -1958
- **Finish** : hot dipped galvanised

diameter rope	width overall	width outside	width inside	length overall	length inside	weight each
a	b	c	d	e	f	kg
inch	inch	inch	inch	inch	inch	
5/16 - 3/8	2 1/8	11/16	1 1/4	4 1/8	3 1/4	0.17
1/2	3	7/8	1 7/8	5 3/4	4 5/8	0.39
5/8	3 3/8	1 1/8	2	6 3/4	5 1/8	0.69
3/4	4 1/4	1 1/4	2 1/2	8 1/4	6 1/4	1.22
15/16 - 1	4 15/16	1 3/8	3	9 5/8	7 3/8	1.62

note: sizes 5/16 and 1/2 are additional and proportional to the specification