

## Stainless Steel Open Body Turnbuckles commercial pattern Hook - Hook

- **Material** : stainless steel AISI 316
- **Finish** : polished
- **Note** : this product is not suitable for lifting purposes

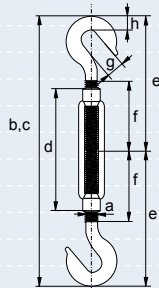

diameter thread	length closed position	length open position	length body	length	length	length	opening hook	thickness	weight each
a mm	b mm	c mm	d mm	e mm	f mm	g mm	h mm	kg	
5	120	175	70	60	40	6	13	0.04	
6	184	270	110	92	55	8	15	0.10	
8	200	280	110	100	57	10.5	15	0.17	
10	234	323	125	117	68	13	11	0.26	
12	260	343	125	130	70	16	13	0.52	
16	322	438	170	161	88	20	17	1.10	

## Stainless Steel Open Body Turnbuckles commercial pattern Hook - Eye

- **Material** : stainless steel AISI 316
- **Finish** : polished
- **Note** : this product is not suitable for lifting purposes

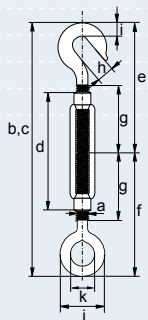
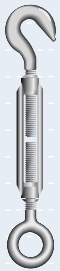

diameter thread	length closed position	length open position	length	length	length	length	length	opening hook	thickness	outside diameter eye	inside diameter eye	weight each
a mm	b mm	c mm	d mm	e mm	f mm	g mm	h mm	i mm	j mm	k mm	kg	
5	110	165	70	55	55	40	6	13	16	7	0.04	
6	172	258	110	77	80	55	8	15	20	9	0.11	
8	184	264	110	85	84	57	10.5	15	22	10	0.20	
10	222	311	125	106	105	68	13	11	31	14	0.28	
12	241	324	125	117	111	70	16	13	35	16	0.43	
16	311	427	170	144	150	88	20	17	47	22	1.00	