

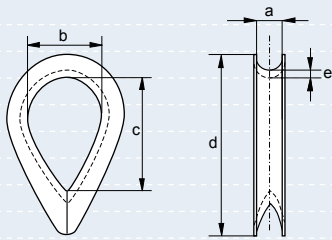

## Stainless Steel Thimbles

### commercial pattern

- **Material** : stainless steel AISI 316
- **Finish** : polished



width groove	width inside	length inside	length	thickness	weight per 100 pcs
a mm	b mm	c mm	d mm	e mm	kg
2	7	12	21	1	0.2
3	10	14	23	1	0.4
4	11	16	25	1	0.6
5	13	21	32	1	0.8
6	15	26	39	1.2	1.4
8	18	35	48	1.5	2.8
10	25	42	55	1.6	4.8
12	29	48	66	1.8	8.0
16	35	62	84	2.0	15.1
20	43	73	99	2	21.7
22	50	84	110	2.1	32.0
24	54	85	120	2.2	66.0

## Stainless Steel Wire Rope Grips

### commercial pattern

- **Material** : Bridge : stainless steel AISI 316  
Nuts : stainless steel AISI 316  
U-bolt : stainless steel AISI 316
- **Finish** : polished

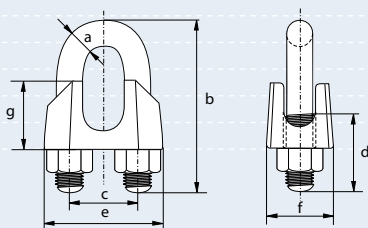
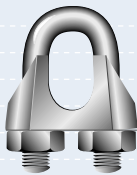

diameter wire rope	diameter bow	length bow	width inside	length thread	length base	thickness base	height base	weight per 100 pcs
mm	a mm	b mm	c mm	d mm	e mm	f mm	g mm	kg
2	3	17	8	10	17	10	10	0.9
3	4	20	9	12	21	10	10	1.0
4	4	23	10	13	21	11	11	1.3
5	5	24	11	13	23	11	10	1.5
6	5	28	13	15	26	12	11	2.1
8	6	34	16	19	30	14	15	4.1
10	8	42	19	22	34	18	17	6.8
13	10	55	24	30	42	23	21	13.0
16	12	63	29	33	50	26	26	21.0
19	12	75	32	38	54	29	30	28.0
22	14	85	37	44	61	33	34	40.0
24	14	95	41	45	65	35	37	42.0