

## Stainless Steel Fork Terminals

### swage type

- Material : stainless steel AISI 316
- Finish : polished

diameter wire rope	diameter inside	diameter outside	diameter pin	length	length inside	width jaw	weight per 100 pcs
mm	a mm	b mm	c mm	d mm	e mm	f mm	kg
3	3.3	6.3	5.2	65	32	7.5	2.3
4	4.3	7.5	6.2	77	40	10	4.9
5	5.3	9	8.7	88	57	12	7.2
6	6.6	12.5	9.7	106	63	14	13.9
8	8.3	16	14.6	145	85	16	21.6
10	10.5	17.8	16.5	150	89	17	52.0

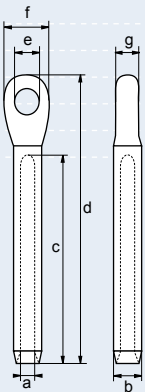

## Stainless Steel Eye Terminals

### swage type

- Material : stainless steel AISI 316
- Finish : polished

diameter wire rope	diameter inside	diameter outside	length inside	length	diameter eye inside	diameter eye outside	thickness eye	weight per 100 pcs
mm	a mm	b mm	c mm	d mm	e mm	f mm	g mm	kg
3	3.2	6.3	36	58	6.5	13	5	1.3
4	4.2	7.5	39	65	8	18	6	2.3
5	5.2	9	50	80	10	22	7	3.9
6	6.3	12.5	62	113	12	26	8	8.6
8	8.3	16	85	139	14	30	10	18.0
10	10.3	17.5	90	152	16	36	12	24.0