

Stainless Steel Rings

commercial pattern

- **Material** : stainless steel AISI 316
- **Finish** : polished
- **Note** : this product is not suitable for lifting purposes

diameter material a mm	diameter inside ring b mm	weight per 100 pcs kg
3	20	0.50
3	35	0.62
4	25	0.90
4	40	1.42
5	35	1.83
5	50	2.80
6	45	3.60
6	60	3.94
8	55	8.51
8	80	9.60
10	50	12.10
10	80	14.43
12	80	16.56
12	100	18.96

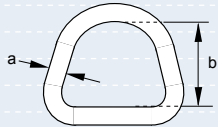
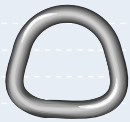

Stainless Steel Dee Rings

commercial pattern

- **Material** : stainless steel AISI 316
- **Finish** : polished
- **Note** : this product is not suitable for lifting purposes

diameter material a mm	inside length b mm	weight per 100 pcs kg
3	20	0.40
3	30	0.54
4	25	0.88
4	40	1.36
5	25	1.64
5	45	2.43
5	50	2.74
6	40	3.40
6	55	3.61
8	50	7.95

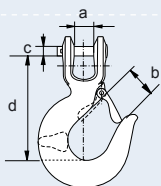

Stainless Steel Clevis Sling Hook

with safety catch

- **Material** : stainless steel AISI 316
- **Finish** : polished
- **Note** : this product is not suitable for lifting purposes

diameter chain mm	width inside jaw a mm	admittance b mm	diameter pin c mm	length bearing points d mm	breaking load kg	weight each kg
6	9	24	10	66	1645	0.18
8	11	27	11	71	2240	0.32
10	15	33	12	82	3800	0.47
12	20	44	16	102	6010	1.10