

## Stainless Steel High Tensile Shackles dee with type A screw collar pin

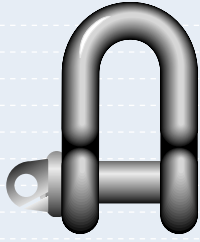

- **Material** : high tensile stainless steel
- **Finish** : polished
- **Certification** : as standard a works proof load certificate is supplied, upon request a certificate of basic raw material and or EC declaration of conformity

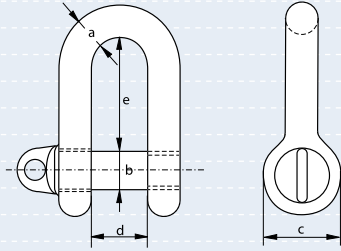

working load limit	diameter bow	diameter pin	diameter eye	width inside	length inside	weight per 100 pcs
tons	a mm	b mm	c mm	d mm	e mm	kg
1	8	10	20	16	32	10.0
2	10	12.7	25	20	40	20.0
3	12.7	16	32	25	50	40.0
5	16	19	38	32	64	70.0
7	19	22	45	38	76	90.0
9	22.2	25	50	44	88	140.0
11	25.4	28.6	56	51	102	220.0
13	28.6	31.8	64	57	114	290.0
15	31.8	34.9	70	64	128	410.0
18	34.9	38	76	70	140	620.0

the above product is also available :- with extra long screw pin plus hole for split pin with countersunk pin with slotted head

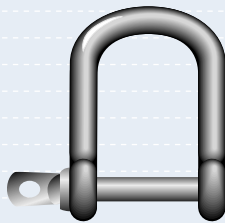

## Stainless Steel Shackles wide jaw dee type with screw collar pin

- **Material** : stainless steel AISI 316
- **Finish** : polished
- **Note** : this product is not suitable for lifting purposes

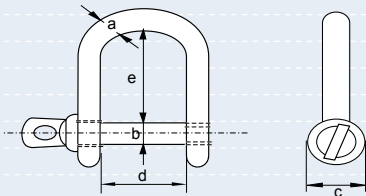

diameter bow	diameter pin	diameter eye	width inside	length inside	weight per 100 pcs
a mm	b mm	c mm	d mm	e mm	kg
5	5	10	20	30	1.6
6	6	12	25	36	2.8
8	8	16	32	47	6.7
10	10	20	40	60	12.2