

Eyenuits

metric coarse & BSW thread

- **Material** : high tensile steel
- **Safety Factor** : MBL equals 5 x SWL
- **Finish** : self colour, electro-galvanised upon request
- **Certificates** : this product is supplied with a works certificate as standard

metric coarse thread

safe working load	diameter thread	diameter eye	diameter base	diameter eye inside	base height	height overall	weight each
tonnes	a mm	b mm	c mm	d mm	e mm	f mm	kg
0.30	10	13	29	44	22	78	0.25
0.50	12	13	29	44	22	78	0.26
0.80	16	13	29	44	22	78	0.27
1.20	20	16	39	49	26	84	0.45
2.20	24	19	44	52	38	111	0.79

bsw thread

safe working load	diameter thread	diameter eye	diameter base	diameter eye inside	base height	height overall	weight each
cwts	a inch	b mm	c mm	d mm	e mm	f mm	kg
5	3/8	13	29	44	22	78	0.24
10	1/2	13	29	44	22	78	0.25
16	5/8	13	29	44	22	78	0.26
24	3/4	16	39	49	26	84	0.45
32	7/8	16	39	49	26	84	0.45
44	1	19	44	52	38	111	0.79

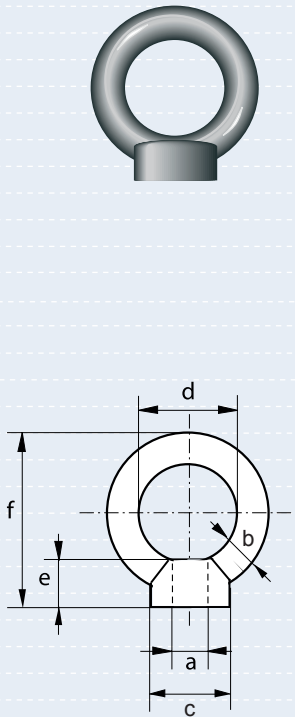

Bownuts

metric coarse & BSW thread

- **Material** : high tensile steel
- **Safety Factor** : MBL equals 5 x SWL
- **Standard** : generally to B.S. 3974 - Part 1 - 1974
- **Finish** : self colour, electro-galvanised upon request
- **Certificates** : this product is supplied with a works certificate as standard

metric coarse thread

safe working load	diameter thread	diameter eye	diameter base	diameter eye inside	base height	height overall	weight each
tonnes	a mm	b mm	c mm	d mm	e mm	f mm	kg
0.23	8	10	32	25	16	64	0.15
0.36	10	10	32	25	16	64	0.15
0.53	12	12	38	30	17	73	0.27
1.01	16	12	38	30	17	73	0.29
1.58	20	14	45	40	25	102	0.50
2.28	24	17	50	50	29	124	0.90
3.65	30	26	70	75	29	149	2.20
5.34	36	26	70	75	29	149	2.20

bsw thread

safe working load	diameter thread	diameter eye	diameter base	diameter eye inside	base height	height overall	weight each
tonnes	a inch	b mm	c mm	d mm	e mm	f mm	kg
0.25	3/8	10	32	25	16	64	0.15
0.50	1/2	12	38	30	17	73	0.27
0.80	5/8	12	38	30	17	73	0.27
1.20	3/4	14	45	40	25	102	0.58
1.60	7/8	14	45	40	25	102	0.58
2.20	1	17	50	50	29	124	0.90
3.50	1 1/4	26	70	75	29	149	2.20
4.75	1 1/2	26	70	75	29	149	2.20

